



Extension
UNIVERSITY OF WISCONSIN-MADISON
MARINETTE COUNTY

Courthouse
1926 Hall Avenue
Marinette, WI 54143
Phone: 715-732-7510



If you will need any type of accommodation or assistance as you attend any Extension sponsored event, please contact the host county or Scott at the Marinette County office at least two days prior to the event. All requests will be confidential.

Scott Reuss
715-732-7510
1-877-884-4408
cell 715-701-0966
scott.reuss@wisc.edu

An EEO/Affirmative Action Employer, University of Wisconsin-Extension provides equal opportunities in employment and programming, including Title IX and ADA requirements.

July, 2023 Newsletter

The last time I wrote a newsletter intro, we had more farms dealing with excess moisture and planting problems than too dry of conditions. Now, the script has flipped and most areas are way too dry, albeit with a high degree of variability within the range of: “our crops are really stressed” to “we’re not in too bad of shape”. The conditions we get in the next 6 weeks will dictate the content of the next newsletter as we get ready for silage season.

If you have anyone on the farm older than 12 years of age but that does not yet have their driver’s license, I hope you will consider enrolling them in the tractor & machinery safety certification courses upcoming in Coleman and Birnamwood. This course is required to be legal for youth to drive tractors and is also a great way to get them to think about safety as part of their daily activities. There is no greater disruption to the farm than when someone gets injured, whether a family member or employee.

Congratulations to the three farms (Curt Kohls, VanDeWalle Farms, and Synergy Dairy) and the three groups that sponsored this year’s area breakfast on the farm events. Some highly variable weather experienced, but all three had great attendance.

Please consider getting me your email address and cell phone number, so that I can add you to electronic notification systems that I will be developing more fully in the near future. Send me a text or email and feel free to send me contact info for others from your farm, as well.

Scott Reuss

Table of Contents:

Page 2	Health Insurance - Covering WI
Page 3	Manure EXPO & NM Regional meetings
Page 4	Tractor & Machinery safety course flier
Page 5	Herbicide PHI’s and forage harvest
Page 6	Badger Crop Connect upcoming sessions
Page 7	Crop management thoughts for the region
Page 8	Winter Wheat and Drones in Ag Field Day

Upcoming Events

July 12 12:30 pm	Badger Crop Connect (pg. 6)
July 13/14 & 20/21	Tractor Safety Certification course in Coleman
July 17/18 & 24/25	Tractor Safety Certification course in Birnamwood
July 19	Winter Wheat and Drones in Agriculture Field Day (pg. 8)
July 26 12:30 pm	Badger Crop Connect (pg. 6)
August 2 nd	Mar. Cty Holstein Association Twilight Mtg
August 9 & 10	Arlington Manure EXPO (pg. 3)
August 25-26	Niagara WI Christmas Tree Growers’ Summer Mtg.
August 30	Arlington Ag Research Station Crops & Soils Field Day

Please watch for news releases or electronic updates for local programs, or contact me to find out precise topics and details.

Worried About Losing your BadgerCare Plus or Medicaid Health Insurance? The First Step is Finding Your Renewal Date

BadgerCare Plus and Medicaid renewals are back, which means all members will need to renew their benefits with the state between June 2023-July 2024. Members should renew within 45 days of their renewal date. Free help from Covering Wisconsin is available now to guide you through the renewal process. [Covering Wisconsin](#) is an Extension program with a statewide network of health insurance navigators and enrollment assisters that provide free, local help with finding and using affordable health insurance, renewals, and financial help like community care.



“The first step, right now,” says Kirk, a navigator at Covering Wisconsin, “is to find out your renewal date. And double check the year. You can find the date in the MyACCESS app or in the letter that the Department of Health Services sent out in March. Some people have dates well into next year. Once you have the date, you can plan your next steps.”

What to Know

- Everyone needs to know their renewal date so they can renew benefits during their 45-day renewal window
- Free help is available from federally and state certified Health Insurance Navigators
- Find your renewal date in the MyACCESS App or at access.wi.gov
- Double check the year and don't renew early!
- There are other options if you no longer qualify

Renew your benefits starting 45 days before your renewal date. **Don't renew early!** If you renew too soon, you could lose your benefits early if you no longer qualify. Members stay insured until their renewal date. A handy how-to sheet is available on the web, email Kirk Moore at kirk.moore@wisc.edu and ask him to send you the link. It has step-by-step instructions for the renewal process and what to do if you can't renew.

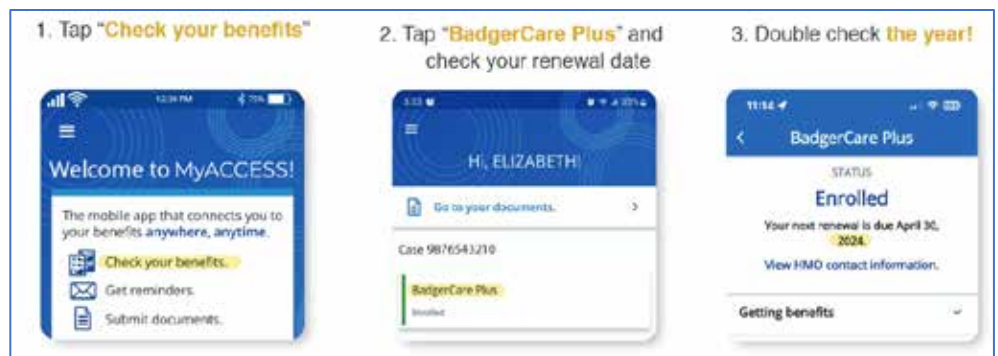

If you no longer qualify for BadgerCare Plus or Medicaid, you may have other options that a navigator can help you find.

“There are many options out there, most people just don't know about them. For instance, navigators can help you find financial help if you have insurance and your deductible is too high,” says Colleen, a Covering Wisconsin navigator.

Getting and keeping health insurance isn't simple, especially if you don't have insurance from your job. Act before your renewal date to keep your insurance going and avoid a gap in your coverage.

Covering Wisconsin is here to provide free, impartial health insurance help. Get help and stay insured.

Contact Kirk Moore for local help:

Kirk Moore

Covering Wisconsin Navigator - Northeastern Wisconsin

1-608-234-0211



The Manure EXPO is at Arlington again this year. The foremost event regarding manure spreading and processing technology. Aug. 9 schedule revolves around tours in the morning and demonstrations in the afternoon, with the expo grounds open and a knowledge challenge toward end of day. August 10 focuses on demonstrations, educational and industry sessions, and more opportunities to interact with the sponsors who make this such an affordable event (\$25 tour registration is only fee for attendees). All the information for the event and the registration link is found through their website at: <https://www.manureexpo.ca/>

Nutrient Management regional meetings

Sponsored by NRCS, DATCP, and the UW NPM program, these meetings are designed for farms who write their own NM plans, agronomists, and agency staff.

Topics will include: + Updates from DATCP and NRCS staff

+ Back to basics: understanding the equations SnapPlus runs in the background.

+Producing readable maps in SnapMaps

+ Understanding winter spreading restrictions + SnapPlus V3

LOCATION		DATE & TIME	REGISTRATION CODE
Wausau	Rib Mountain Municipal Use Center 227800 Snowbird Ave Wausau, WI 54401	August 28 th 9am-12pm	https://conta.cc/40SPkXa
Oshkosh	James P Coughlin Center (JPCC) 625 E. County Road Y Oshkosh, WI 54901	August 29 th 9am-12pm	https://conta.cc/3nYvUBG
Eau Claire	CVTC Eau Claire Campus 620 W Clairemont Ave Eau Claire, WI 54701	August 31 st 9am-12pm	https://conta.cc/3mml5Jk
Jefferson	Jefferson County Highway Department 1425 South Wisconsin Drive, Jefferson, WI 53549	September 6 th 9am-12pm	https://conta.cc/3GuegvS

2023 Youth Tractor and Machinery Safety Training



Pound Town Hall – Coleman, WI on Thurs/Fri, July 13/14 and 20/21

Birnamwood Community Center – Mon/Tues July 17/18 and 24/25

Cost: \$45/person

9 a.m. to 3:15 pm

Who Needs To Attend the Training? Any 12 to 15-year old who may need to drive any type of farm machinery on a public road in Wisconsin. Others are welcome to attend the course, but only those older than 12 will receive certification. Those 16 years old and older without a valid driver’s license can also utilize this training to be legal to drive farm machinery on public roads.

Legal Review: In Wisconsin, 14 and 15 year-olds who have successfully passed the Wisconsin Safe Operation of Tractor and Farm Machinery Course can legally drive farm machinery on public roads for their parents or grandparents’ farms AND can work for other farms and do the same. 12 and 13-year olds who have completed the course can legally drive farm machinery on public roads only when working for their parents or grandparents’ farms. If you employ persons under 15 years or who do not have a driver’s license, it is highly recommended that you have them attend the training, whether they drive on public roads or not. You may want to talk to your insurance agent to double-check about requirements based on your insurance policy.

Some Logistics:

– **All participants MUST be in attendance on July 21 or 25 for testing.** You can miss one of the other days and complete self-study to ‘make up’ that time, but must be at testing day.

– Participants need to bring their own lunches, a refrigerator will be available for storage. Families are welcome to provide snacks, Scott will have water and/or lemonade and/or milk available.

– The course will emphasize hands-on and skill-building exercises, including first aid and fire safety from local emergency response personnel. We will be analyzing machinery for safety aspects, conducting on-farm safety assessments, and dozens of other activities, along with videos and course material review.

Call Scott Reuss, Regional Crops/Soils Educator, at either 715-732-7510 or call/text to 715-701-0966 if you have any questions, or you can e-mail to scott.reuss@wisc.edu

Circle Site Attending

Registration Form - Tractor & Machinery Safety - please print

Coleman

Birnamwood

Name(s): _____ Age(s): _____

Mailing Address: _____

City: _____ Zip code: _____

Emergency Contact Telephone Number: _____

Please complete this form and mail to the following address by July 11, with a check for \$45 per participant and made payable to UW-Extension. OR contact Scott with the above information by then!

Marinette County Extension
1926 Hall Avenue
Marinette, WI 54143

Considering diverting portions of your grain crops or cover crops into feed crops? Don't forget to check the preharvest intervals for applied crop protection products!

With the dry conditions we are experiencing this year in much of Wisconsin (and beyond), securing enough feed becomes a concern and top priority for dairy farmers and livestock producers. As farmers consider diverting portions of their grain crops into feed crops, it's important that they consider and respect the **preharvest intervals** for all crop protection products applied to their crops during the growing season.

The preharvest interval (PHI) is the minimum amount of time between the application of a crop protection product (i.e., herbicide, fungicide, insecticide) and when the treated crop can be legally harvested for forage/grazing or for grain. The U.S. Environmental Protection Agency (US EPA) has set limits on the residue levels ("tolerances") of registered crop protection products for each labeled crop and the PHIs are in place to help meet these safety standards thus reduce the risk of animal and/or human dietary exposure. The PHI information is available on the product label, typically under "Restrictions". Note that the PHI may or may not be the same for forage/grazing and for grain harvest. See below for examples of the PHI information found on the label of common corn herbicides:

- **DiFlexx herbicide (dicamba, Group 4):** *"Corn forage may not be harvested within 45 days of the final DIFLEXX Herbicide application. Corn grain and stover may be harvested once the crop has reached the ensilage (milk) stage."*
- **Status herbicide (dicamba+ diflufenzopyr, Groups 4 and 19):** *"DO NOT apply within 32 days before corn forage harvest" and "DO NOT apply within 72 days before popcorn, corn grain and stover harvest."*
- **Aatrex 4L herbicide (atrazine, Group 5):** *"Note for all applications to corn: Do not graze or feed forage from treated areas for 60 days following application, or illegal residues may result. For sweet corn, do not graze or feed forage from treated areas for 45 days following application, or illegal residues may result."*
- **Roundup PowerMAX3 herbicide (glyphosate, Group 9):** *"Allow a minimum of 50 days between application of this product and harvest of corn forage or grain" and "Allow a minimum of 7 days between application and harvest or feeding of corn stover or grain."*
- **Dual II Magnum herbicide (S-metolachlor, Group 15):** *"DO NOT graze or feed forage for 30 days following application."*
- **Callisto herbicide (mesotrione, Group 27):** *"Do not harvest forage, grain, or stover within 45 days after application."*

For additional information, please check: [A3646 Pest Management in Wisconsin Field Crops](#). Always check the product label. ***The label is the law.***

This article was written by Dr. Rodrigo Werle, Associate Professor and Extension Cropping Systems Weed Scientist at the University of Wisconsin-Madison.



Badger Crop Connect

TIMELY CROP UPDATES FOR WISCONSIN

July 12, 2023, 12:30-1:30 pm

Combine Cleaning for Small Grain Harvest and 2023 Cover Cropping Impacts

Dan Smith, UW-Madison Nutrient and Pest Management Outreach Specialist

Corn Pollination and Development Stages

Dr. Joe Lauer, UW Madison Professor and Extension-funded Faculty of Agronomy

CEUs available

For more information and registration links scan the QR code or visit:
<https://cropsandsoils.extension.wisc.edu/programs/badger-crop-connect/>



July 26 BCC Program: Dr. Matt Ruark – Cover Crop Selection and Management after Corn Silage; Forage alternatives for 2023 or early 2024.

August 9 – No BCC due to Manure Expo

August 23 BCC Program: Corn Silage Prep Edition: Managing harvest in an uneven year; nitrates; storage issues with inconsistent moisture; pricing corn silage for sale/purchase. Featuring Dr. Joe Lauer and others.

Past Badger Crop Connect videos are available at the website listed above.

2023 Crop Conditions: Up, Down, and All Around

To say the least, this has (so far) been a growing season to try to forget for our region. We had some areas with significant planting delays due to excess moisture, followed by the driest May and June that many farms can remember ever seeing. I'm not going to try to project what that means for the rest of the year, as things could change. But, based on the conditions we know we have in play, here are some things to be thinking about and/or doing yet this summer.

1. Uneven Crop Emergence and its impacts. Primarily being seen on later planted crops and where there was any type of tillage prior to planting. However, can be found in no-till fields and sporadically throughout most fields. Two different phenomenon that are showing up, and both can cause us issues as we progress through the year. First is bare spots where the seeds started to sprout but dried up and died. The yield loss is obvious when we don't have a crop plant or areas of no plants. However, the other issues are increased weed management concerns and extra wildlife damage due to the spotty stands inviting deer and other critters into the field. These fields may need to be scouted an extra time or two and consider spot-spraying weed infestations before they become significant issues down the road.

Differing maturities within field may also lead to extra disease and insect opportunities, as the proper window for infection/attraction is longer. Lastly, maturity convergence may not be very good. This is likely to be much worse with corn than beans, but there will be potential problems in all. The most significant

2. Poor weed control. Many acres of crops sprayed with pre-emergence herbicides did not receive timely rain in sufficient quantity to fully activate the herbicides. When we did get rain, it became a guessing game as to how much control was left from the pre's and when we should spray post products. If we waited too long, we have weeds that may be too large for some post-emerge products to truly work well. If we sprayed too early, we may have to come back again with another product/application. If doing so, make sure you really read labels and don't go over active ingredient maximums for the growing season.



Left photo shows two very different groups of emerging soybeans due to planting in uneven soil moisture. Photo below shows uneven germination, fully bare spots, and weed control problems all in one. The 2023 trifecta, as it were.



Winter Wheat Management Field Day

Also Featuring Drones in Agriculture

Wednesday, July 19th 10 a.m. to 2 p.m.

LeMere Farms; 4140 Cty. Hwy. J; Abrams, WI
1.5 miles north of Hwy. 41 on Cty. J, or take
Liegeois Road east from Hwy. 141 to J, turn north onto J and look for Parking signs.



A DJI Matrice drone flies inches above a field during a test flight at UW-Madison's West Madison Agricultural Research Station. Photo: Michael P. King

Featuring Dr. Shawn Conley, Winter Wheat and Soy Agronomist; Dr. Damon Smith, Field Crops Plant Pathologist; Dr. Brian Luck, Biological Systems Engineer; Jamie Patton, NRCS Soil Scientist; Dan Marzu, UW Nutrient & Pest Management Program; and Kevin Jarek & Scott Reuss, Regional Crop/Soils Educators.

- 10 a.m. Registration (NOTE: topic order & timing may change.)
- 10:15 a.m. Cover crop and forage crop opportunities and realities after wheat
- 11 a.m. Winter Wheat agronomics & Disease Management – Dr.'s Conley & Smith
- Noon Lunch – provided by Seed Concepts, Inc. and possible other sponsors.
- 12:45 Drones in Agriculture – Dr. Luck
- 1:30 Wheat nutrient management research and current rec.'s. View nitrogen rate, nitrogen timing, and sulfur rate research plots, and fungicide demonstration plots.

Topics will include wheat agronomics; disease identification and management; cover crop and after-wheat forage options; drone usage in agriculture; nutrient management; and Q & A opportunities throughout with each presenter.

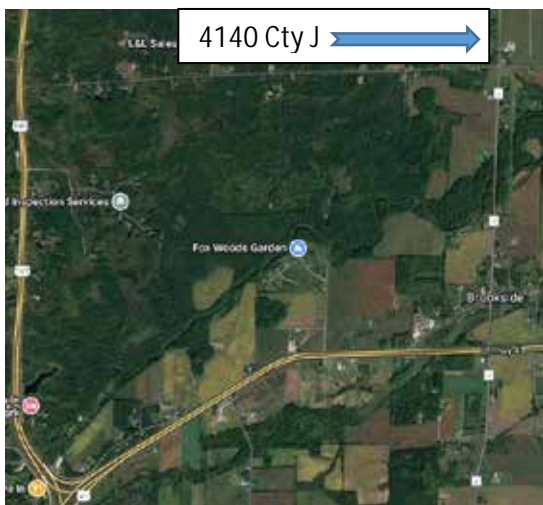

Free to attend, with lunch provided by Seed Concepts, Inc. Registration requested to ensure adequate supplies and food available. Register by July 17 if possible, by contacting Scott Reuss via email at scott.reuss@wisc.edu or call/text him at 715-701-0966. You can also contact him for more information.

An EEO/AA employer, University of Wisconsin-Madison Division of Extension provides equal opportunities in employment and programming, including Title VI, Title IX, the Americans with Disabilities Act (ADA) and Section 504 of the Rehabilitation Act requirements. If you need any reasonable accommodation to attend this program, please contact Nancy Servais at 715-732-7514 at least 2 days prior to the date of the program.